

THE VILLAS AT EMERALD ESTATES

LEGEND:

- SINGLE-FAMILY LOTS AVAILABLE
- VILLA LOTS
- OPEN SPACE

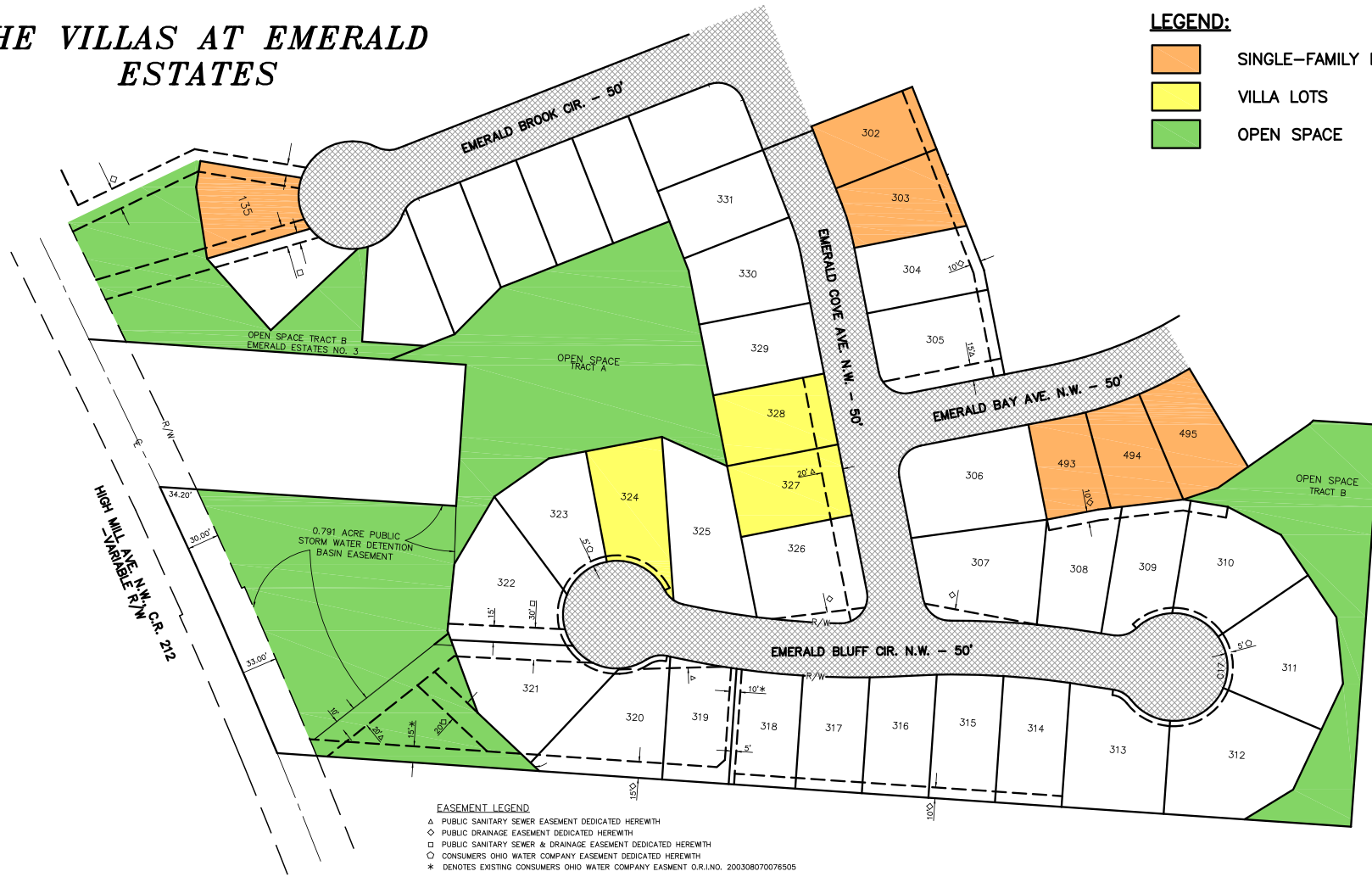

EASEMENT LEGEND
 ▲ PUBLIC SANITARY SEWER EASEMENT DEDICATED HEREWITH
 ◆ PUBLIC DRAINAGE EASEMENT DEDICATED HEREWITH
 □ PUBLIC SANITARY SEWER & DRAINAGE EASEMENT DEDICATED HEREWITH
 ○ CONSUMERS OHIO WATER COMPANY EASEMENT DEDICATED HEREWITH
 * DENOTES EXISTING CONSUMERS OHIO WATER COMPANY EASMENT O.R.L.NO. 200308070076505

About this community

The gently rolling hills of Augusta Lakes are located amid 27 holes and spectacular views of The Legends golf course. We offer a choice of housing tailored to fit your lifestyle. Choose from single family home sites (with or without golf course views) or one of our beautiful ranch style villas with care free living. Imagine living your dream on one of Stark County's premier golf courses. Whatever you're looking for in a home, it's only a short drive to Massillon's newest and most exciting golf course community! Custom Homes and Villas starting in the \$200s.

Amenities

- Paved streets with curbs
- Street lighting & sidewalks
- Underground utilities
- Close to public & private schools
- Easy access to major highways
- Adjacent to The Legends golf course

PREPARED BY:

HAMMONTREE & ASSOCIATES, LIMITED
 ENGINEERS, PLANNERS, SURVEYORS
 5233 STONEHAM RD. NORTH CANTON, OH 44720
 PHN: (330) 499-8817 FAX: (330) 499-0149
 TOLL FREE: 1-800-394-8817
 www.hammontree-engineers.com

R:\Stark\Townships\Jackson\Gintud\SMEMRLD\2017 Emerald Estates Marketing Plot.dwg - 3/07/17 - 4:22pm - lbooster